

FieldPro 530si

Quick Start Guide

This guide provides information on the daily use of the FieldPro 530si printer. For additional information, please refer to the FieldPro 530si User Guide.

BEFORE you begin, please visit www.printek.com Support; Downloads; Drivers and Software, to download the FP530 printer driver.

Printer features

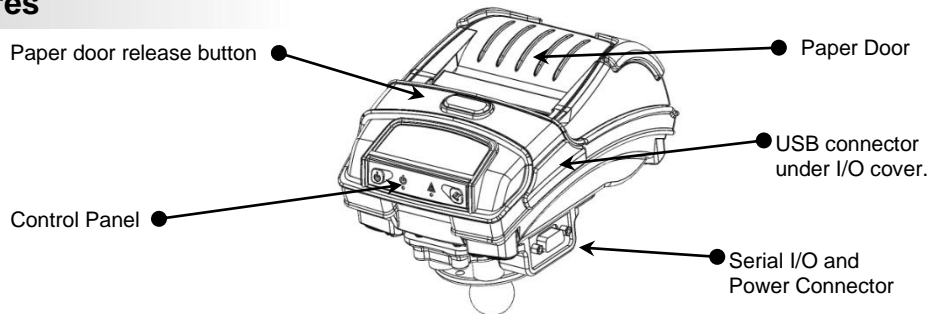

Media

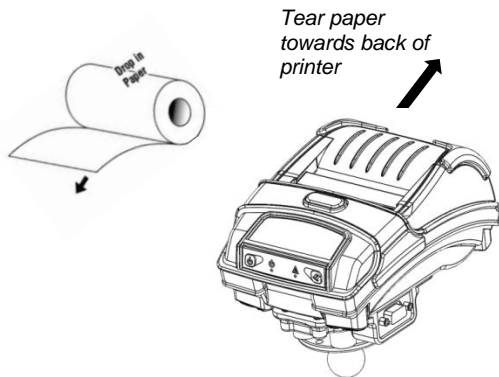

Press Paper door release button to open the paper compartment. Pull small leader of paper out and close paper door "Clicks" when properly closed.

Serial I/O and Power Cable

Use table to connect Power and RS232 serial communication.

Serial Cable

Pin	Color	Description
2	White	Receive Data (from Host)
3	Green or Red	Transmit Data (from Printer)
5	Black	Ground

Power Cable

Pin	Color	Description
5	Black	Ground
8	Red	Power

Mount Dimensions

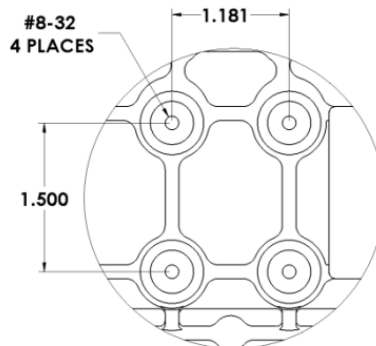





Drivers, User Manuals, and SW Utilities available @ www.printek.com

FieldPro FP530si Quick Start Guide

Control Panel indicators



Power & Status (Green/Red) 	Alert (Red) 	Indication
On	On	Booting up
On	Off	Ready
On	Flashing	Paper Error/Lid Open
Flashing	Off	Job is arriving
Flashing	Off	Job is printing
Flashing	Flashing	IP over USB active
x	x	Charging Battery
		Battery Low

	Function:	How to:
Power Button 	Power up Power down Toggle IP over USB on/off	Press & Release Press & Hold Press Twice
Paper feed button 	Advance paper Print self-test	Press once Press twice

Self-Test / Configuration print out



To print the configuration report and self-test: With Power on, press the paper feed button twice quickly.
To access configuration menu refer to Operator's Manual.

USB Access to Printer Web Pages

1. Connect USB cable from printer to host
2. With printer turned on, set the printer into configuration mode by double-clicking the POWER button. Both the Power LED and Fault LED will flash together.
3. Open browser on your host and type 169.254.200.1 into the address bar of the browser (**Note:** Firefox or Chrome will work best) and hit Enter.
4. A login box should appear.

FP530 Configuration Interface

Password:

www.printek.com

5. Type "0000" and hit Enter- you should now be at the home page for FP530 Configuration.
6. To return the printer to normal operating mode, double-click the POWER button. The Power LED will be returned to a solid light.



Once the printer is connected via USB and in *IP over USB* mode it is temporarily not possible to access the Internet.



Drivers, User Manuals, and SW Utilities available @ www.printek.com